



EVERLAST LED VICTORY SHOE BOX

240W / 30,275LM

The EVERLAST LED VICTORY SHOE BOX 240w fixture achieves 30,275 LUMENS.

The EVERLAST LED VICTORY SHOE BOX offers enhanced illumination for a large outdoor area. Strategic placement of the die-cast aluminum VICTORY SHOE BOX will provide a powerful and effective light distribution (type V).

The sleek housing of the VICTORY SHOE BOX offers through-hole design to minimize the effects of extreme outdoor conditions.

Available sensors include on/off, bi-level, and dusk-to-dawn.

APPLICATION

Parking areas and garages, street and roadway lighting, automotive dealership, tennis court and walkway applications.

FEATURES & BENEFITS

- 10-year Limited Warranty.
- Inventronics LED Driver offers high performance and unprecedented quality.
- Performance engineered clear polycarbonate lens assembly delivers effective beam angles and reduces glare.
- Luxeon LED chips provide high flux density to enable directional and high lumen applications.

LED & OPTICAL ASSEMBLY

- Luxeon LED
- 80 CRI
- Type V Light Distribution
- LM-79 Tests in accordance with IESNA standards

APPROVALS / LISTINGS

- DLC Listed
- ETL Listed to UL1598
- EPA Rating: 1.46 ft²
- BUG Rating: B5-U0-G2
- IP65 per ANSI C126.25-2009
- Temperature rated -22° to 122°F (-30° to 50°C)
- CE / RoHS compliant
- LM80 & TM21 data available on request

MATERIALS

Diecast aluminum driver housing.

SIZE / WEIGHT (PACKAGED)

27.6" x 14.9" x 5.3" (36.8" x 17.0" x 8.8")
32.0 lbs. (36.0 lbs.)

MOUNTING HARDWARE

Two options available - adjustable u-bracket (AUB) & knuckle slip fitter (KSF)

FIXTURE

SIDE

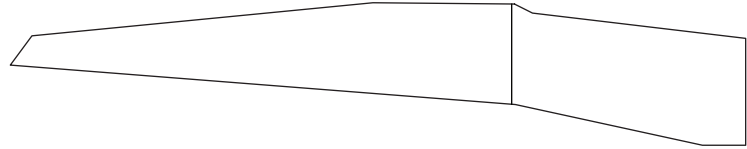

TOP

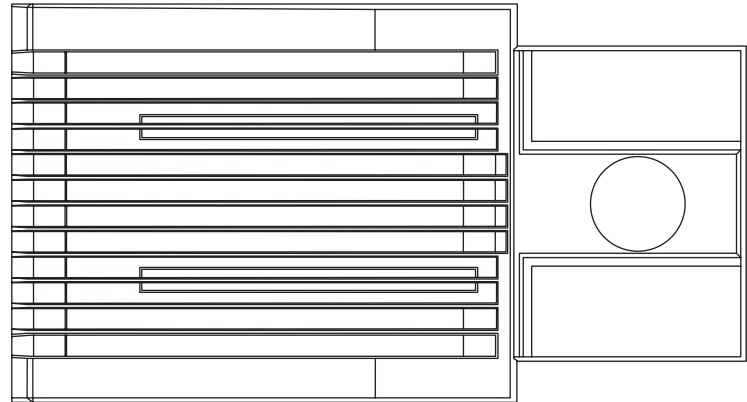

FACE

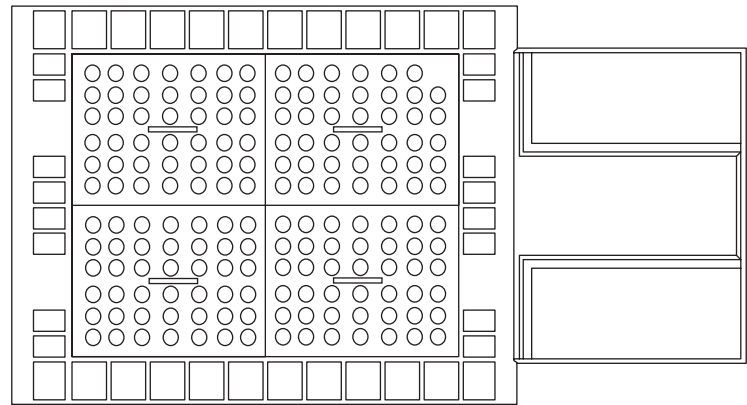

PC · BLPC
PHOTOCELL ·
BLANK PHOTOCELL

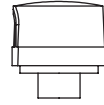

BASE

EL-LED-VS-

240-

FIXTURE

EL-LED-VS-
EVERLAST LED VICTORY SHOE BOX

WATTAGE

240 WATT
30,275 LUMENS

VOLTAGE

UL UNIVERSAL
(120-277V AC)
UH UNIVERSAL
(347-480v AC)

ACCESSORY

COLOR TEMP.

65 6500K / 80 CRI
57 5700K / 80 CRI
50 5000K / 80 CRI
40 4000K / 80 CRI

DISTRIBUTION

V TYPE V

SENSOR

OF ON / OFF
BL BILEVEL
PC NEMA PHOTOCELL
BLPC BLANK PHOTOCELL

MOUNT (PAGE 2)

AUB ADJUSTABLE U-BRACKET
KSF KNUCKLE SLIP FITTER

OTHER

SP10 10kV SURGE PROTECTOR



EVERLAST LED VICTORY SHOE BOX 240W / 30,275LM

SPECS

EMITTER (LUXEON) & DRIVER (INVENTRONICS)

| SYSTEM WATTS (120-277V AC) | INITIAL DELIVERED LUMENS (5000K) 80CRI | NUMBER OF LEDS | TOTAL CURRENT / FIXTURE | | | | |
|-------------------------------|---|----------------|-------------------------|---------|---------|---------|---------|
| | | | 120V AC | 208V AC | 240V AC | 277V AC | 480V AC |
| 240 | 30,275 | 168 | 2.00 | 1.15 | 1.00 | 0.87 | 0.50 |

INPUT

| VOLTAGE RANGE | FREQUENCY RANGE | POWER FACTOR | TOTAL HARMONIC DISTORTION (DURING OUTPUT LOAD) | EFFICIENCY (230V AC / 277V AC) |
|-------------------------|-----------------|--------------|---|-----------------------------------|
| 100-277V AC 347-480V AC | 50 / 60 Hz | 0.92 | THD < 15% | >92% |

DIMENSIONS

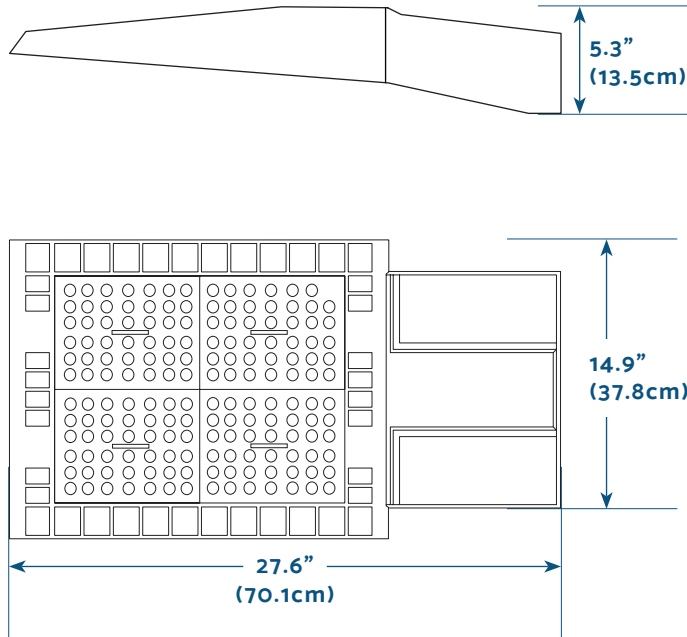

MOUNTS

ADJUSTABLE U-BRACKET (AUB)

TOTAL DIMENSIONS

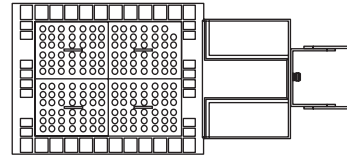

| LENGTH | WIDTH | HEIGHT |
|--------|--------|--------|
| 33.9" | 14.9" | 5.3" |
| 86.1cm | 37.8cm | 13.5cm |

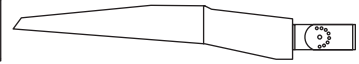

KNUCKLE SLIP FITTER (KSF)

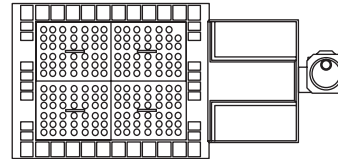

| LENGTH | WIDTH | HEIGHT |
|--------|--------|--------|
| 31.9" | 14.9" | 9.0" |
| 81.0cm | 37.8cm | 22.9cm |

