

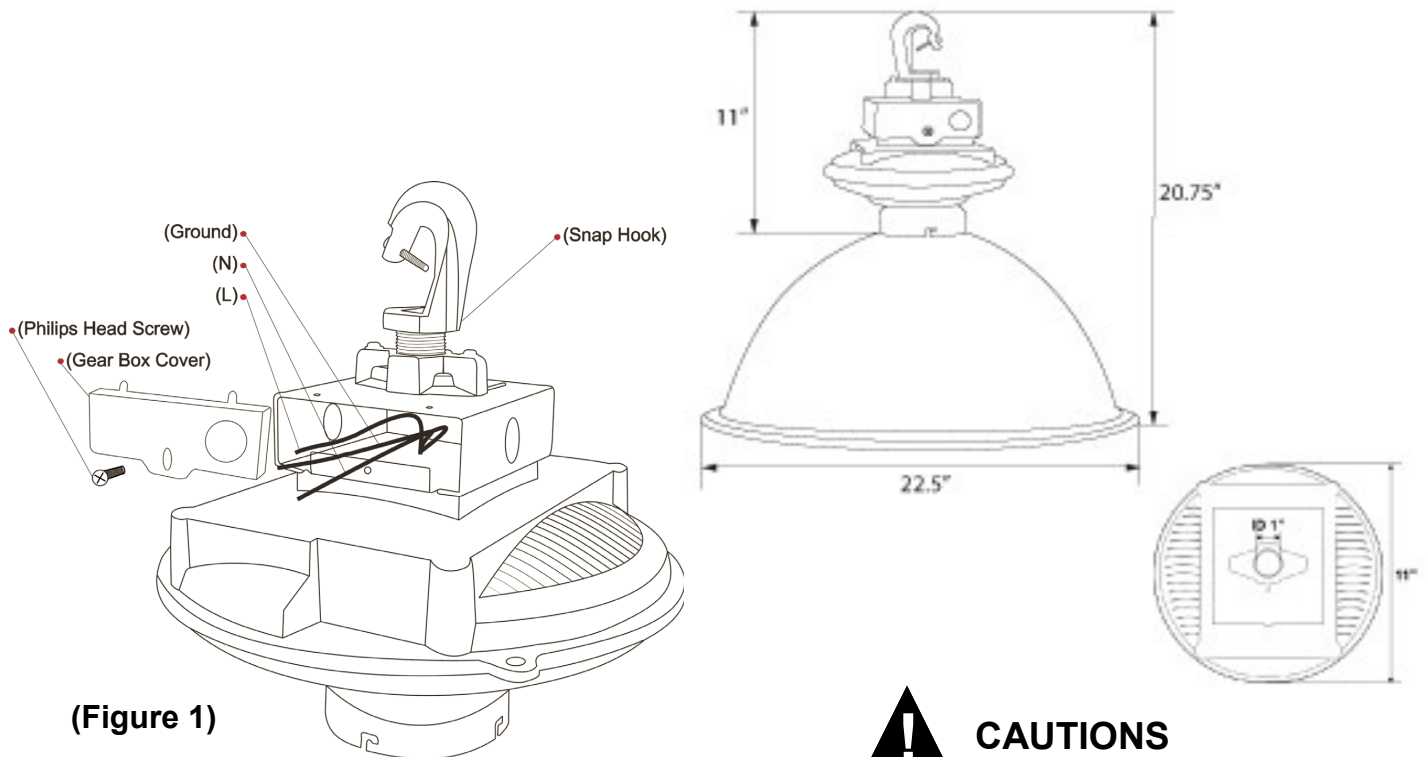

EHBUS-AC INSTALLATION INSTRUCTIONS



(Figure 1)

Fixture Mounting & Wiring

1. Use hook for pendulum mounting; Phillips screw located on the hook can be adjusted for varying applications. For pendant mounting remove hook. To remove mounting hook loosen the set screw at the base of the hook and turn the mounting hook counter clockwise. Once removed the fixture can be screwed onto a 3/4" (NTP) threaded rigid conduit for pendant mounting (Fig. 1).
2. Remove screw located in the center of face plate on gear box using Phillips screw driver. Remove face plate/cover of gear box.
3. Feed incoming wires down through the mounting hook and/or 3/4" mounting hole on top of gear box (Fig. 1). See wiring diagram on reverse side to complete fixture wiring (Fig. 2).
4. Replace gear box cover, replace Phillips screw.



CAUTIONS

1. Fixtures are suitable for Dry Locations Only.
2. The product shall be installed and serviced by a competent and certified electrician and in compliance with applicable installation code. To avoid the possibility of electrical shock, turn off power supply and allow lamp to cool before installing.
3. Efficient and reliable grounding is a must not only for personal protection, but also for the proper use of the electronic ballast to meet the national standard of EMC without interference to the equipment.
4. The luminaries shall be installed in an area with good ventilation, no corrosive gas and no combustible or explosive objects. The ambient temperature ranging from -20°F to 122°F.
5. The supply voltage is allowed to be varied at +10% to -10%. It will influence the normal start and operation of lamp and damage the electronic ballast if outside this range.



Standard Wiring

120-277v Wiring

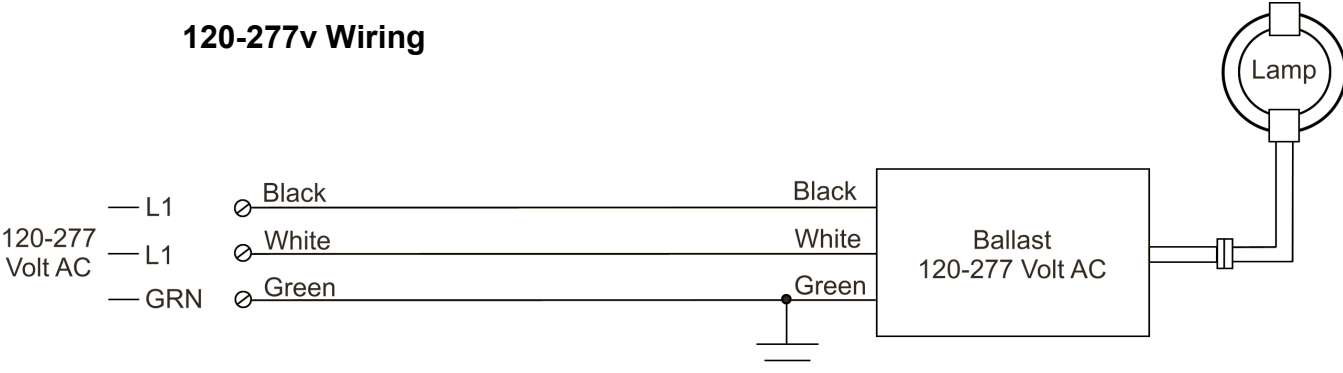

(Figure 2)