

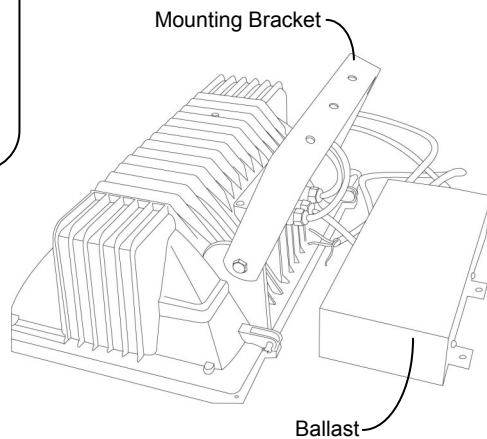

EFL-ED (120w-200w) INSTALLATION INSTRUCTIONS

Tools Required

- Wire Strippers
- Adjustable Wrench



(Figure 1A)

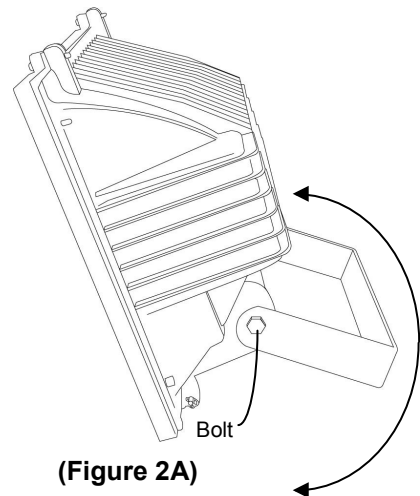

(Figure 2A)

Surface Mounting

1. Place mounting bracket and ballast in desired location on mounting surface; mark holes for drilling. **(Figure 1A).**
2. Drill holes in mounting surface.
3. Secure mounting bracket and ballast to surface with appropriate anchors and/or hardware.
4. Loosen bolts mounting bracket, move until fixture is set to desired angle **(Figure 2A).**
5. Tighten bolts.

Electrical Wiring

1. Hard wire: Connect power supply ground wire to fixture ground wire, connect power supply line wire to fixture line wire, connect power supply neutral wire to fixture neutral wire **(Figure 1B & 2B).**
2. Push excess wire back into mounting surface and seal.
3. Junction Box: Connect power supply line wire to fixture line wire, connect power supply neutral wire to fixture neutral wire, connect fixture ground wire to junction box ground screw **(Figure 1B & 2B).**



CAUTIONS

1. The product shall be installed by a certified individual in compliance with installation code. To avoid the possibility of electrical shock, turn off power supply and allow lamp to cool before installation, replacement or repair.
2. Efficient and reliable grounding is a necessity for personal protection, as well as proper use of the electronic ballast in order to meet the national standard of EMC without Interference to the equipment.
3. The luminaires shall be installed in an area with good ventilation, no corrosive gas, no combustible or explosive objects and with ambient temperatures ranging between -20°F to 122°F.
4. The supply voltage is variable between -10% and +10%. The supply voltage will influence the normal start and operation of lamp as well as damage the electronic ballast if outside this range.



Standard Wiring

(Figure 1B)

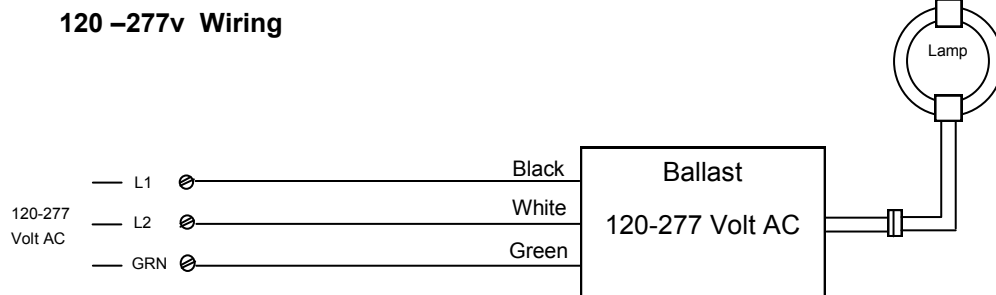

Photocell Application

(Figure 2B)

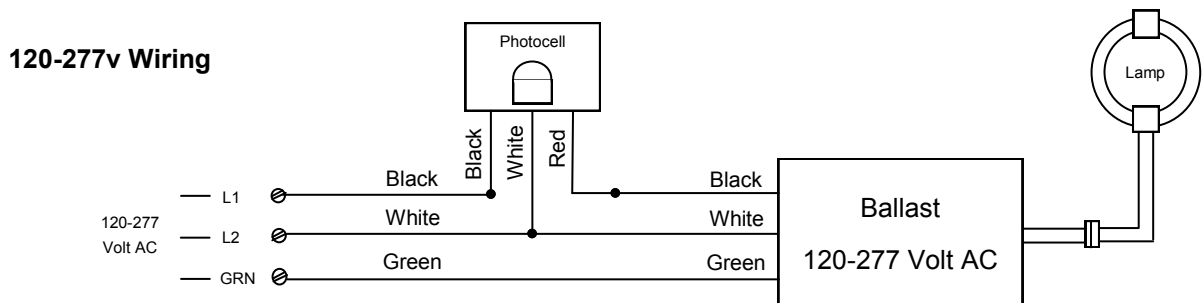

120w-200w Fixture Dimensions

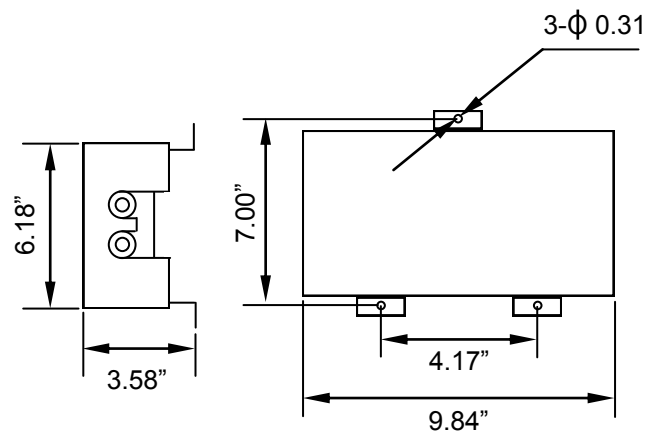
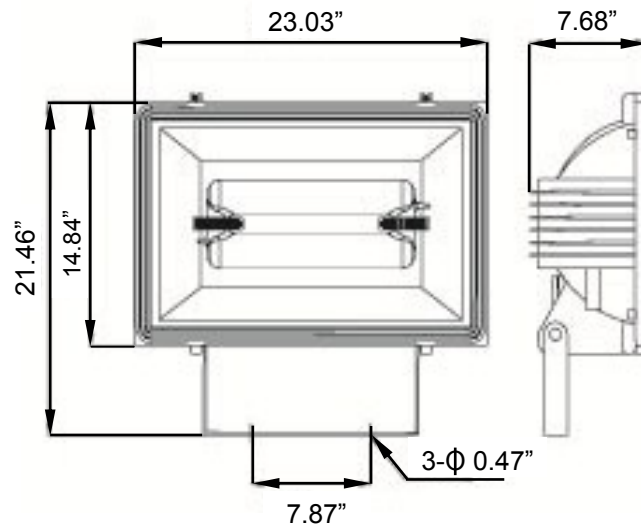

(120w-150w Ballast)

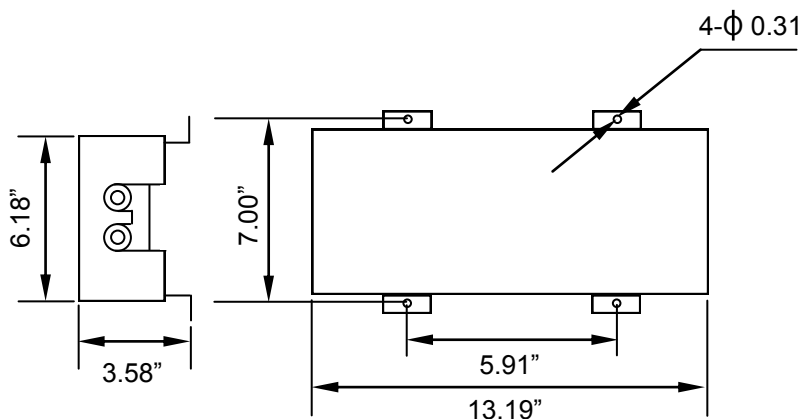

(200w Ballast)