



## Pendant Walkway



### Description

- Series: EPW-EC
- Lamp Life Rating: 100,000 hours
- Lumen Maintenance: 70% over 100,000 hours
- Light Output: 5000K, 82-85 CRI
- IP Rating: 54
- Applications: Parks, shopping malls, outlets, plazas, city halls, historic areas, city sidewalks
- Warranty: 10 Year Limited

### Specifications and Patent Pending Features

- Pendant design with corrosion resistant powder coated aluminum alloy housing
- Universal pendant mount with bubble lens provides effective light distribution and reduced glare
- Recessed lamp reduces high beam angle and promotes dark sky integrity
- Induction lamp geometry ideal for even Type V distribution
- Electronic ballast with high power factor
- Excellent vibration and shock resistance

## Ordering Information

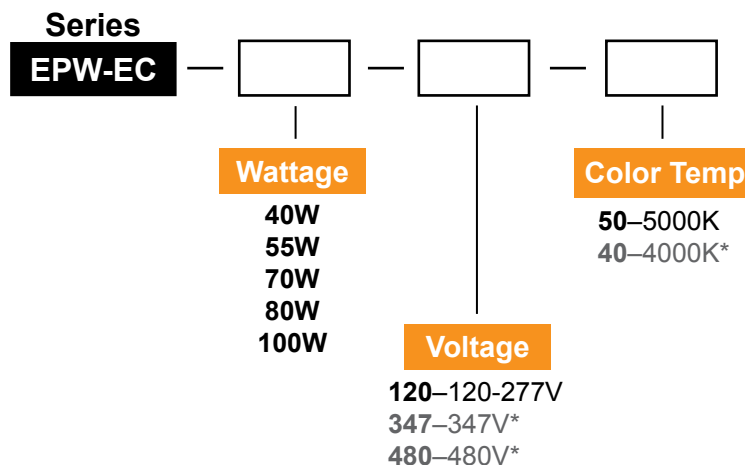

**Bold** = Standard

**Grey \*** = Upgrade options available upon request

Example: **EPW-EC-40-120-50**

Call Toll Free: 888-383-7578

[www.everlastlight.com](http://www.everlastlight.com)

© 2013 EverLast® Lighting, LLC. All Rights Reserved. Published by EverLast® Lighting, LLC, 2021 Wellworth Avenue, Jackson, Michigan 49203.  
Reproduction in part or whole of this document in any commercial uses including publication, broadcasting or redistribution in any medium without the prior written permission of the publisher is prohibited.



## Dimensions

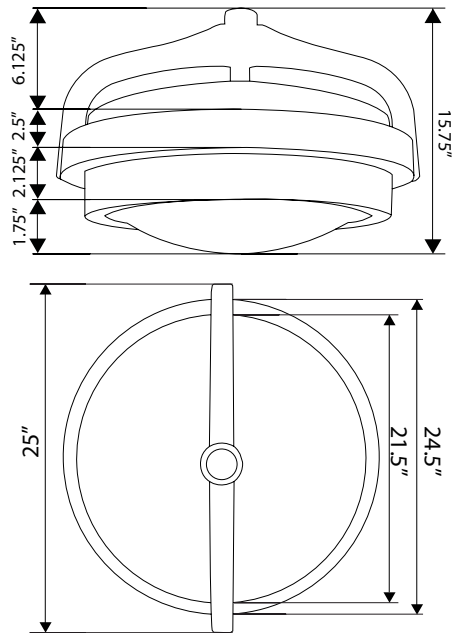

## Photometric Data

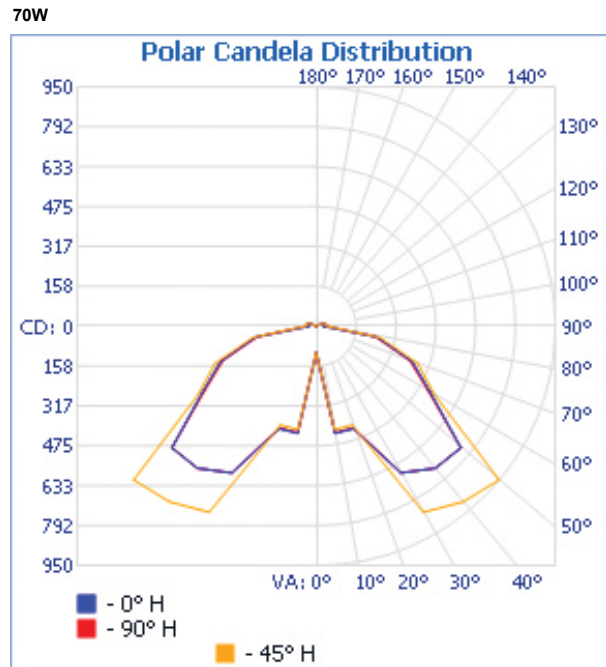

## Lamp Specifications

Wattage	Lumens	L/W Ratio	CRI	CCT (KELVIN)	Rated Life
40W	3,350	84	82-85	5000	100,000 hours
55W	4,650	84	82-85	5000	100,000 hours
70W	5,900	84	82-85	5000	100,000 hours
80W	7,150	84	82-85	5000	100,000 hours
100W	8,400	84	82-85	5000	100,000 hours

## Ballast Specifications

System Wattage	Input Voltage	Input Current	Input Freq.	Power Factor	Ambient Temp	THD
EB-40W	120-277V/480V*	0.38-0.17A / 0.10A	50/60Hz	>0.95	-40 to 130 F°	<10%
EB-55W	120-277V/480V*	0.50-0.21A / 0.13A	50/60Hz	>0.95	-40 to 130 F°	<10%
EB-70W	120-277V/480V*	0.63-0.29A / 0.16A	50/60Hz	>0.95	-40 to 130 F°	<10%
EB-80W	120-277V/480V*	0.70-0.32A / 0.19A	50/60Hz	>0.95	-40 to 130 F°	<10%
EB-100W	120-277V/480V*	0.93-0.42A / 0.22A	50/60Hz	>0.95	-40 to 130 F°	<10%

## Application Image



City Streets

Call Toll Free: 888-383-7578

[www.everlastlight.com](http://www.everlastlight.com)

© 2013 EverLast® Lighting, LLC. All Rights Reserved. Published by EverLast® Lighting, LLC, 2021 Wellworth Avenue, Jackson, Michigan 49203. Reproduction in part or whole of this document in any commercial uses including publication, broadcasting or redistribution in any medium without the prior written permission of the publisher is prohibited.